

INSTRUCTION

48-2016



Flat Polymero

311945.002.3.76

IP 40 IK03
 220 - 240 V / 50 - 60 Hz
 LED
 5 x 1,5 mm²
 2,50 mm²

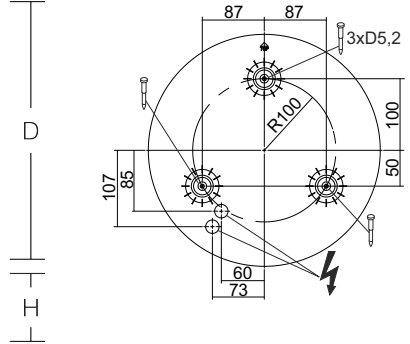
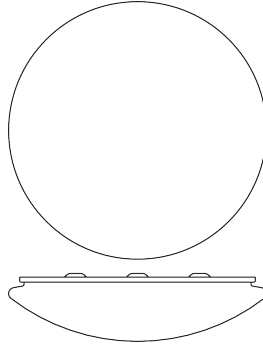

311945.002.3.76	D 360, H 100	LED	13,5 W	1,28 kg
Φ	EEL _{LED}	EEL	CRI	CCT
1200 lm	A+	A+	83	4000K
B10	B16	C10	C16	I max, I max/2, T50
114	182	114	182	0,1 A

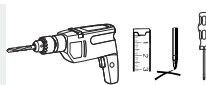
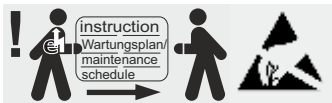

Die Leuchte darf nur mit ihren vollständigen Schutzabdeckungen betrieben werden.
The luminaire must be used with its complete protective covers only.

EN 12464

EN 12464

RZB
Rudolf Zimmermann,
Bamberg GmbH
 Rheinstraße 16
 D-96052 Bamberg
 Deutschland
 Telefon +49 951/79 09-0
 Telefax +49 951/79 09-198
 www.rzb.de
 info@rzb-leuchten.de

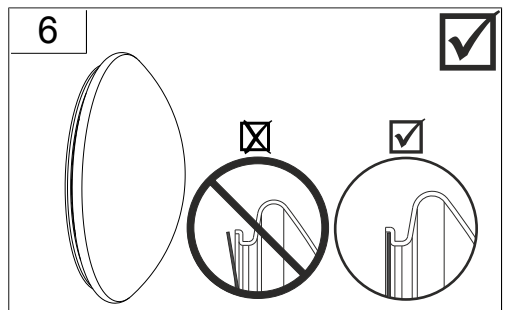
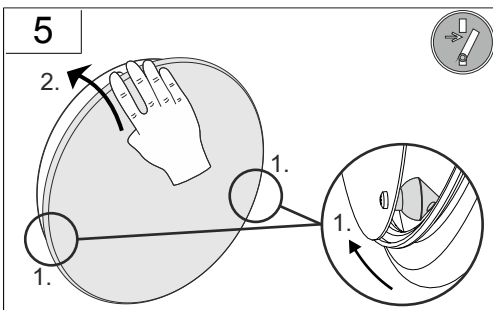
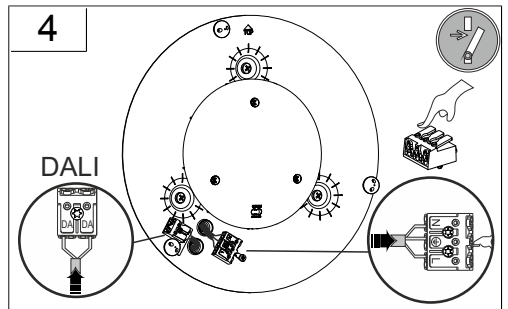
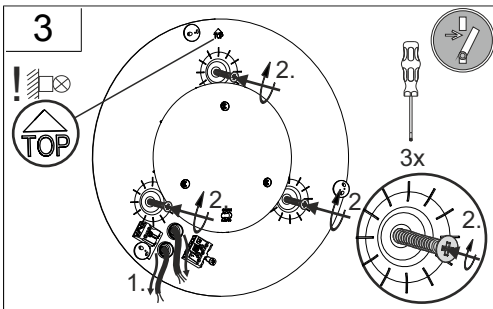
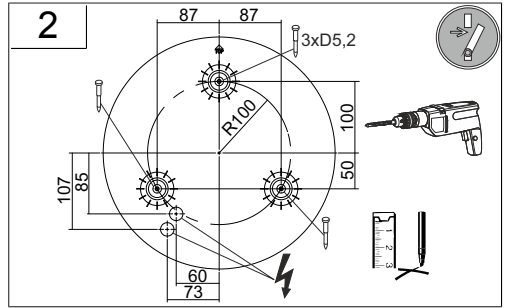
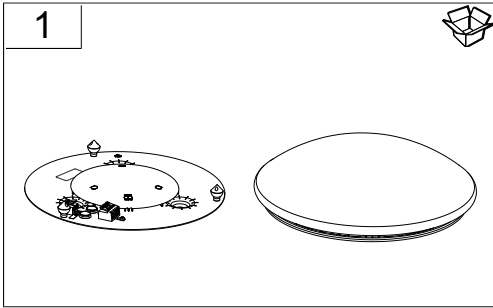

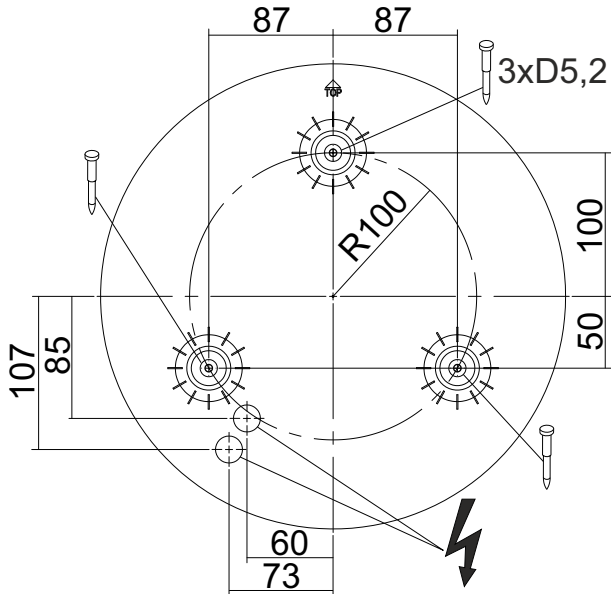



DIN 4844



Vor Wartung oder Reparatur freischalten/
power off before maintenance or repair



	981804.002	D 380, H 19	351 g
	981804.004	D 380, H 19	351 g
	981804.0042	D 380, H 19	340 g



	08-311161.012	Ersatzdiffusor PMMA D 360	330 g
--	---------------	---------------------------	-------